



Treppenhaus B1

Treppenhaus B2

Wohnungsgrösse

Bad	4.8 m ²
Wohnen Schlafen	38.3 m ²
	43.1 m²

NF gerundet gem. SIA 416

2.Obergeschoss

Wohnung B1.2.3

1.5 Zimmer

43.1 m²

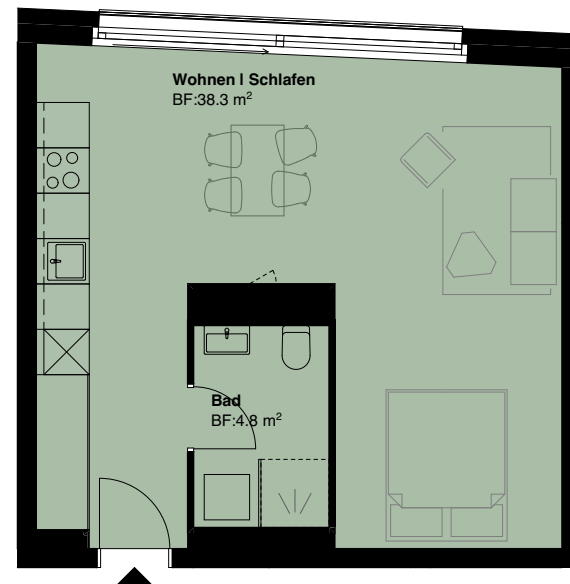

ERSTVERMIETUNG

REALIT TREUHAND AG

Isabella Fringer
Bahnhofstrasse 41, 5600 Lenzburg
Telefon 062 885 88 31
isabella.fringer@realit.ch www.realit.ch

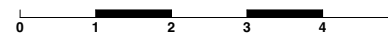
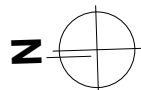

Massstab 1:100